



*Venue Specs*

# SALZHAUS WINTERTHUR

*Concert Hall & Music Club*

**CAPACITY**

Shows: 700 + Guests / Parties: 900

**SALZHAUS ONLINE TOUR** 

# SOUND



# Venue Specs

Salzhaus Winterthur

Untere Vogelsangstrasse 6

P.O. Box 2355

CH-8400 Winterthur

Switzerland

## Engineer in Charge

Sebastian Schlegel

sebastian.schlegel@salzhaus.ch

## Booking

Michael Breitschmid

michael.breitschmid@salzhaus.ch

Nico Schulthess

nico.schulthess@salzhaus.ch

## PA MAIN HALL

**Tops** 3 x L-acoustics ARCS per Side

**Subs** 6 x L-acoustics SB218

**Center Fill** 2 x L-acoustics 108 XT

**Delayline** 2 x L-acoustics MTD 112b

**Backfill** 4 x Kling & Freitag CA 1215

Controlled by Dolby Lake Processor LP4D12

Amped by LA 8 and Lab.Gruppen

## PA INDIGO (FOYER)

**Tops** 2 x Kling & Freitag 1215

**Subs** 2 x Martin Audio DV Subs

Controlled by Dolby Lake Contour

Amped by Lab.Gruppen

## FOH

**FOH Desk** Yamaha PM 3500 (48 Inputs, 8 Aux, 8 Subgroups, 12 Matrix)

**FOH FX** 1 x TC D-TWO

1 x TC 2290 Delay

1 x Eventide H 3000 Harmonizer / Multi

**FX** 1 x Lexicon 300 L Reverb

1 x TC M-2000 Multi FX

1 x Yamaha SPX 900 Multi FX

**FOH Insert** 1 x BSS DPR 404

(4 Channel Compressor / De-esser)

1 x BSS DPR 402

(2 Channel Compressor / De-esser)

1 x BSS DPR 901 II (Dynamic EQ)

8 x DBX 160 Compressor

1 x Drawmer DL 221 (Dual Compressor / Limiter)

1 x Klark DN 360 (2 x 31 Band graph. EQ)

1 x Klark Square One (8 Channel Gate or Compressor)

1 x TL Audio C-1 (Dual Valve Preamp & Compressor)

1 x UREI LA-22

# SALZHAUS

Salzhaus GmbH · Untere Vogelsangstrasse 6 · Postfach 2355 · 8400 Winterthur · Switzerland

+41 52 204 05 54 · info@salzhaus.ch · www.salzhaus.ch

**MONITORS**

<b>Monitor Desk</b>	Midas m32
<b>Wedges</b>	12 x Martin Audio LE12JB (1 used as Listen Wedge) 2 x Martin Audio W2
<b>Drumsub</b>	2 x Martin Audio DV Sub
<b>Sidefills (only on special request)</b>	2x Kling & Freitag I215 2x Kling & Freitag I8'

Controlled by Dolby Lake Processor LP4D12  
Amped by Martin Amps (Lab.Gruppen)

**MULTICORES**

40 Channel 3way Passive Split (Stageright)
40 Channel Multicore (Stageright to FOH)
10 Channel Return Multicore (FOH to Stageright)

**INTERCOM**

1 x ASL BS217 Masterstation (Stageright)
1 x ASL BS17 Beltpack

**RISERS**

<b>Platforms</b>	6 x Büttec 2xlm
<b>Legs</b>	8 x 0.2m 24 x 0.4m 16 x 0.8m

**MICROPHONES (SMALL CHANGES MAY HAPPEN FROM TIME TO TIME)**

<b>Dynamic</b>	5 x Shure SM 58 2 x Shure Beta 58 2 x Shure Beta 58 A 5 x Shure SM 57 1 x Shure Beta 57 3 x Shure Beta 57 A 1 x Shure SM 91 1 x Shure Beta 91 1 x Shure Beta 52 A 1 x EV PL 20 2 x Sennheiser MD 421 U 1 x Sennheiser MD 441 5 x Sennheiser e604 2 x Sennheiser e906 1 x Audix D1 1 x Audix D2 1 x Audix D3
----------------	---

<b>Condenser</b>	2 x AKG SE 300 B 2 x AKG C 460 B 2 x Audix ADX51 2 x Suter C2
------------------	--

<b>D.I.s</b>	2 x BSS ARI33 2 x Radial Pro DI 1 x Radial Pro DII 2 x Palmer Pan 04 some more oldschool D.I.s
--------------	--

**DJ EQUIPMENT**

<b>DJ Mixer</b>	1 x Pioneer DJM 900NXS 1 x Pioneer DJM 900NXS2
<b>CD-Player</b>	2 x Pioneer CDJ 2000NXS 2 x Pioneer CDJ 2000
<b>Turntables</b>	2 x Technics SL-1210 MK2 2 x Technics SL-1210 MK5
<b>DJ Monitoring</b>	2 x Martin Audio W2 2 x Martin Audio DV Sub

**SALZHAUS**



## STAGE

<b>Back Wall</b>	12 x Showtec Active Sunstripe
<b>Back</b>	16 x Par 64 500W MFL 8 x GLP Impression X4 6 x JB P7 2 x Martin Atomic 3000 2 x ACL Group PAR 36 4 x Raylight
<b>Mid</b>	8 x GLP Impression X4S 3 x 500W Fresnel
<b>Front &gt; Stage</b>	8 x Fresnel 1000W 6 x GLP Impression X4S 6 x Par64 500W MFL
<b>Sides</b>	4 x GLP Impression X4S
<b>Front &gt; Audience</b>	4 x 2Lite Blinder 1 x 500W Fresnel

<b>Add. Floor Lights</b>	6 x GLP Impression X4S 6 x PAR 64 Short 500W MFL
<b>Haze</b>	1 x Look Unique 2.1 1 x Antari HZ-500
<b>Dimmers</b>	4 x 12Ch LitePutter (12 freie Kanäle)
<b>Desk</b>	Chamsys MQ100 Pro 2014 2 x Chamsys Extra Wing 1x Touch Screen 24
<b>Add. Power</b>	2 x 32A or 1x 32A + 2x 16A 2 free DMX-Lines Stage-FOH

**Please note: Due to low clearance, there is no truss.  
All lamps are directly mounted to the wooden ceiling  
and can therefore not be removed or changed.**

**Hanging Backdrop**  
Width: 3.50 m, Height: 3 m

## PARTYLIGHTS MAIN HALL

9 x Stairville MHX200ProSpot
2 x American DJ Event Bar

## OUR TOY PROJECTORS

<b>Stage front Left &amp; Right</b>	Acer X137WH WXGA 3700lm
<b>Stage front center</b>	BenQ ca. 3000lm

# SALZHAUS



## Notable Surroundings & Directions

### SALZHAUS

[Directions](#) ▶

[Online Tour](#) ▶

### WINTERTHUR STATION

[Directions](#) ▶

### PARKHOTEL BLOOM

[Directions](#) ▶

### HOTEL WARTMANN

[Directions](#) ▶

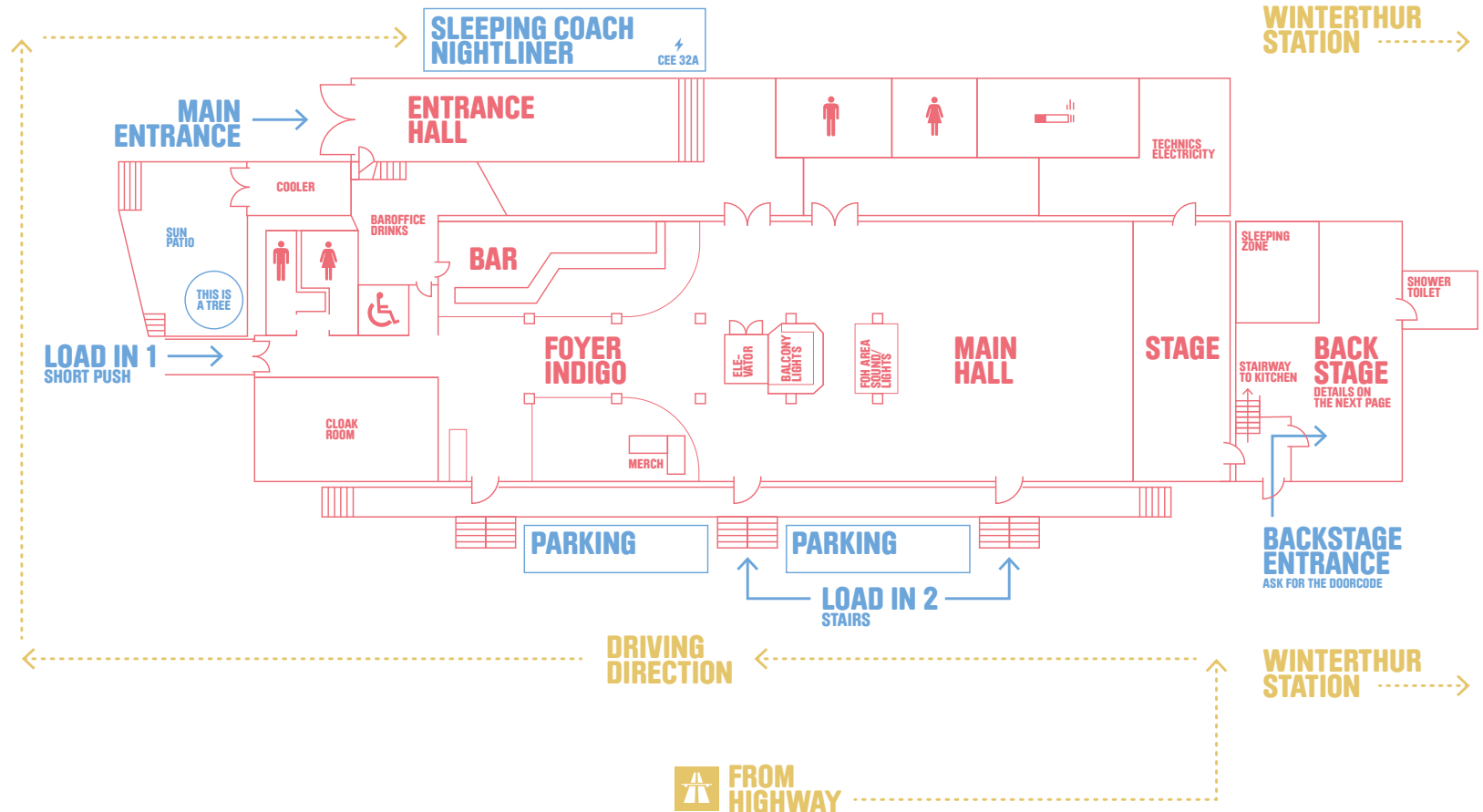

## SALZHAUS

# BACKSTAGE



Venue Specs

Salzhaus Backstage –  
epic pleasure on 90 m<sup>2</sup>!

## WIFI-CONNECTION

WiFi salzhaus\_guest

Password salz\_guest15

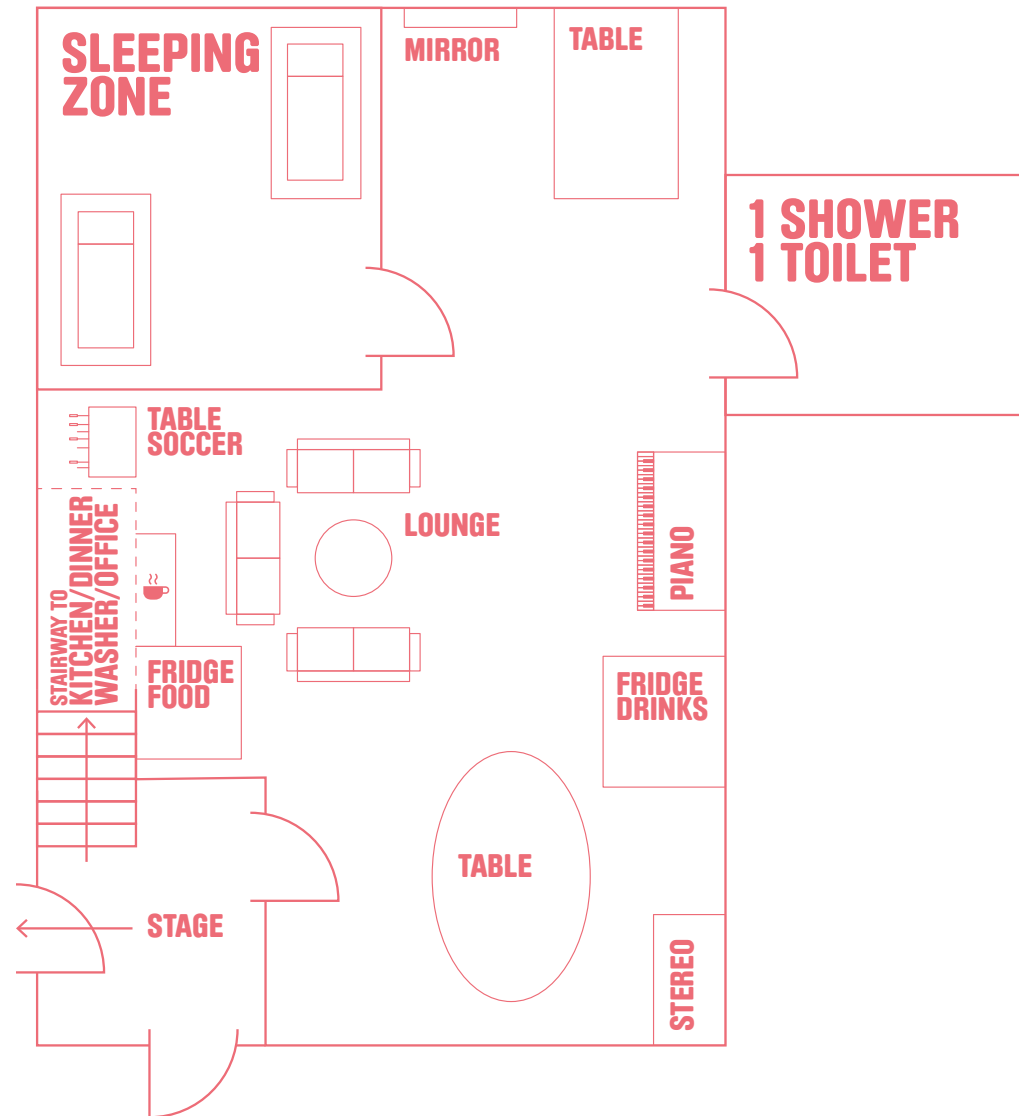

## SALZHAUS

Salzhaus GmbH · Untere Vogelsangstrasse 6 · Postfach 2355 · 8400 Winterthur · Switzerland  
+41 52 204 05 54 · info@salzhaus.ch · www.salzhaus.ch

# STAGE



# Venue Specs

No trusses. Wooden ceiling with cross beams and stringers.

## AERIAL VIEW

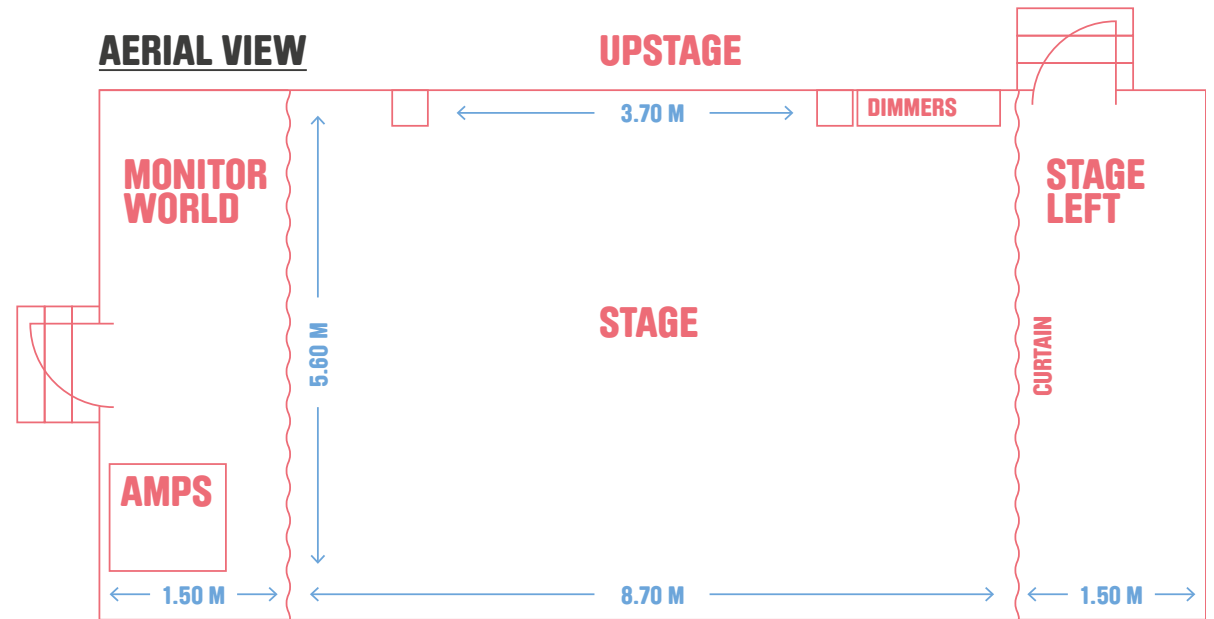

## DOWNSTAGE VIEW

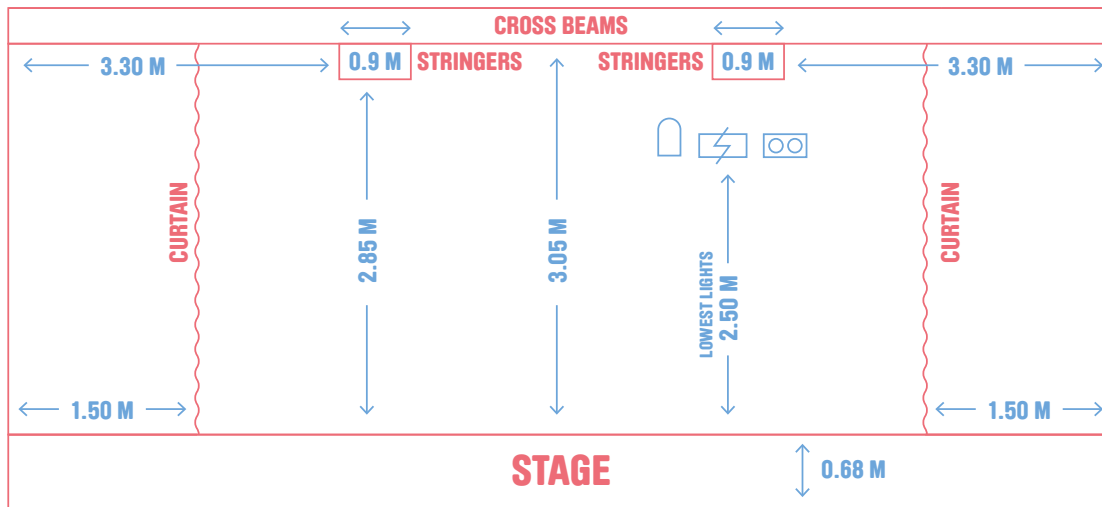

## DOWNSTAGE

## SALZHAUS



## CAPTION

-  PAR64

---

-  GLP Impression X4

---

-  Raylight

---

-  ACL

---

-  JB Lighting P7

---

-  Martin Atomic 3000

---

-  GLP Impression X4S (Washer)

---

-  2Lite Blinder

---

-  Back: Showtec Active Sunstrip

---

-  Fresnel 1000W

---

-  Fresnel 500W

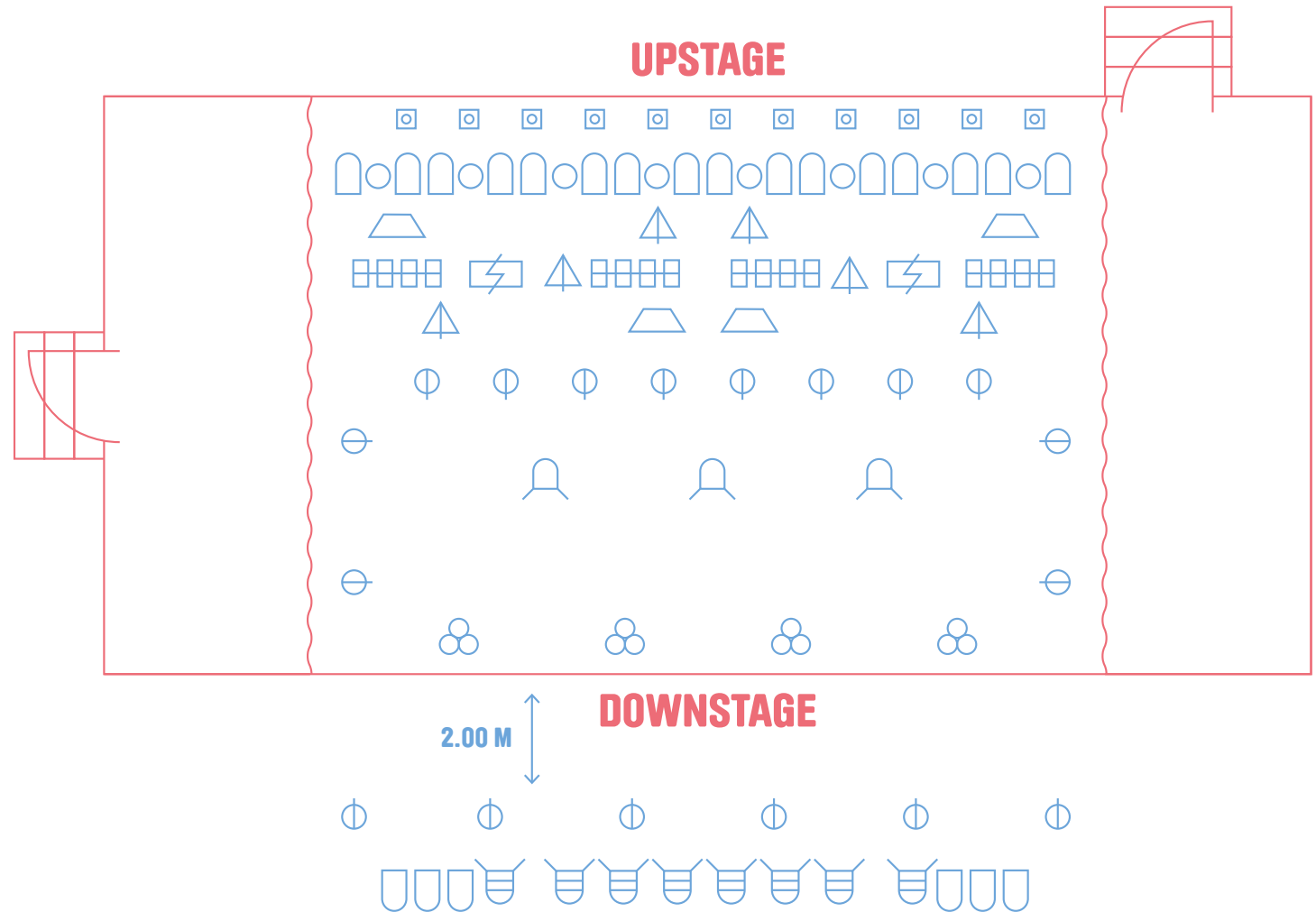

## SALZHAUS